

- Potential Uses:**
- Aquarium
 - Arcade
 - Artist Workshops
 - Commercial Office
 - Galleries
 - Movie Theatre
 - Professional Suites
 - Residential Over
 - Restaurant
 - Retail
 - Spa/Fitness Center
 - Studio Apartments
 - Whirlpool Product Center

**Civic Area
Waterfront Plaza**

- Paddle Boat Rentals
- Performance Stage
- Concessions
- Outdoor Events
- Festival Venues
- Waterfront Concert Pavilion
- Fountain/Flag/Carillon Plaza

Modern Plastics

**Site
Riverfront
Promenade**

- Maintain Canopy Trees where possible
- Highly Detailed Waterfront Treatments
- Outdoor Dining
- Concessions
- Boat Rentals
- Pedestrian Bridges over Ox Creek
- Project-Wide Pedestrian Connection
- Festival Venues
- Measured Jogging Course
- Information Kiosks

Ox Creek

**Benton Harbor
Portal**

- Signage Features
- Primary View Window into Project from North Shore Drive/Arrival Portal to City of Benton Harbor
- Water Feature
- Boat Rentals
- Ice Skating during Winter Time

**Open Grove
Linear Park**

- Free Play Areas
- Picnic Lawns
- Benches/Pits
- Pedestrian Connection to Downtown

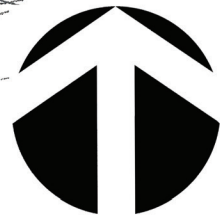

NORTH

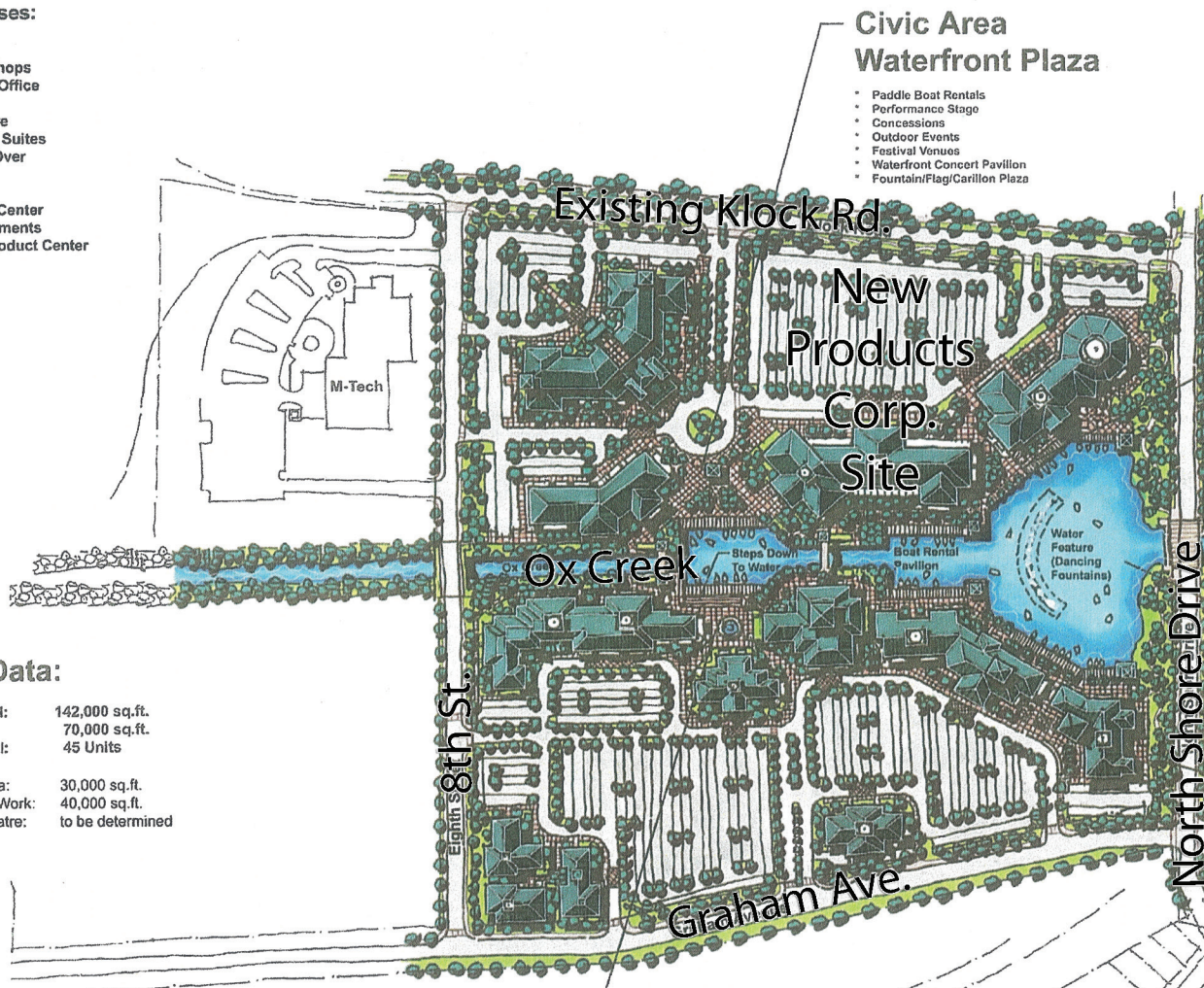

Site Data:

Total Retail:	142,000 sq.ft.
Office:	70,000 sq.ft.
Residential:	45 Units
Fitness/Spa:	30,000 sq.ft.
Artist Live/Work:	40,000 sq.ft.
Movie Theatre:	to be determined

Civic Area

- Central City Park/Gathering Spot
- Art/Craft/Display Areas
- Outdoor Educational Events
- Musical Performances

**PRELIMINARY SITE PLAN
PARCELS 8A, 10, 10A, 11, 11A, 24 & 25
HARBOR SHORES, ST. JOSEPH AND BENTON HARBOR, MICHIGAN**

Site Plan
The Site Plan is a preliminary architectural conceptual plan based on information available at the time of design. Information given herein has been obtained from a variety of non-performing sources to include aerial photographs, engineering drawings, etc. It is intended to show conceptual details. There can be generally considered variable data and not engineering drawings. The configuration of water bodies, public areas, alignment of roads, buildings, and other may not accurately reflect conditions as they presently exist or future site conditions when all development services are completed.

Descriptive text added to original drawings for location and clarification.